



Lydden Grove

London, SW18

£550,000

Lydden Grove is a lovely quaint road near to Wandsworth Town centre and within 0.6 miles* of Earlsfield Mainline Station. This well-presented ground floor conversion flat has its own west facing garden, two double bedrooms, a living room as well as a separate kitchen. It is spacious, well located and would make an ideal first-time purchase for someone looking to live in the Wandsworth/Earlsfield area.

As well as giving good access to Earlsfield Mainline Station, the property is within 0.6 miles* of Southside's Shopping Centre and central Wandsworth that offers a vast array of bars, shops, restaurants, gyms and wellness facilities.

This property is ideal for a young family, a couple looking for a spacious property with WFH options or friends looking to find a property that can house two people in equal proportions.

We highly recommend you have a look around, so give us a ring or send an email and we will happily give you more information.

Viewing

Please contact our Carrie Scott Office on 02088711729 if you wish to arrange a viewing appointment for this property or require further information.

- Ground Floor period conversion
- Two double bedrooms
- Reception room leading on the garden
- Private garden
- Kitchen
- Well presented throughout
- 0.6 miles to Earlsfield train station
- 0.6 miles to Southsides shopping centre
- Minutes from King Georges park
- Ideal first time purchase



2



1



1



C

Floor Plan

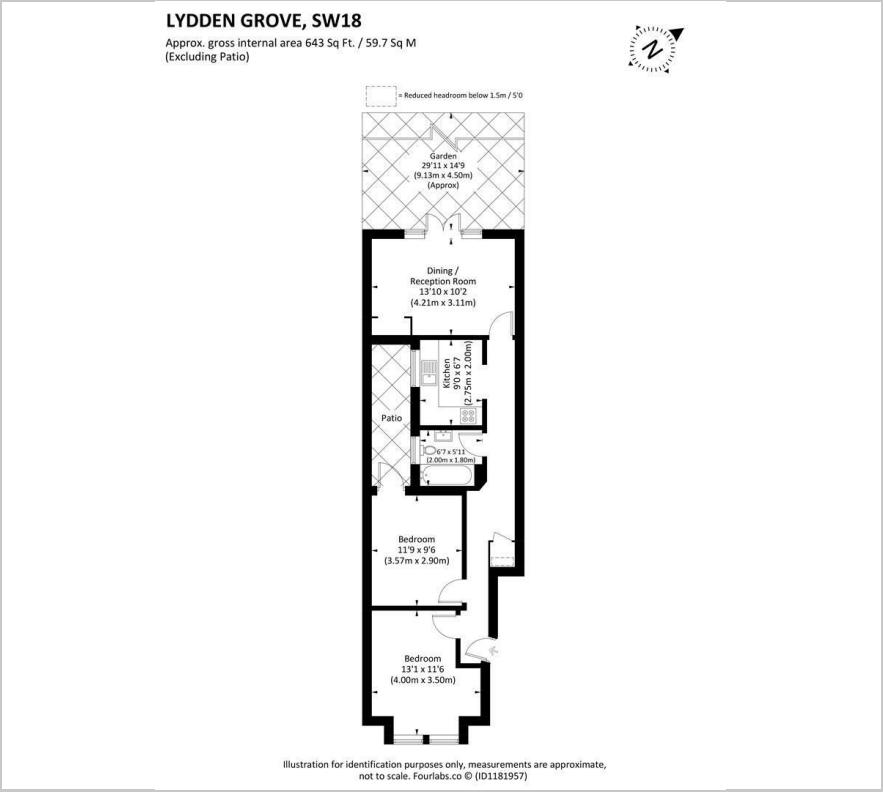

Energy Efficiency Graph

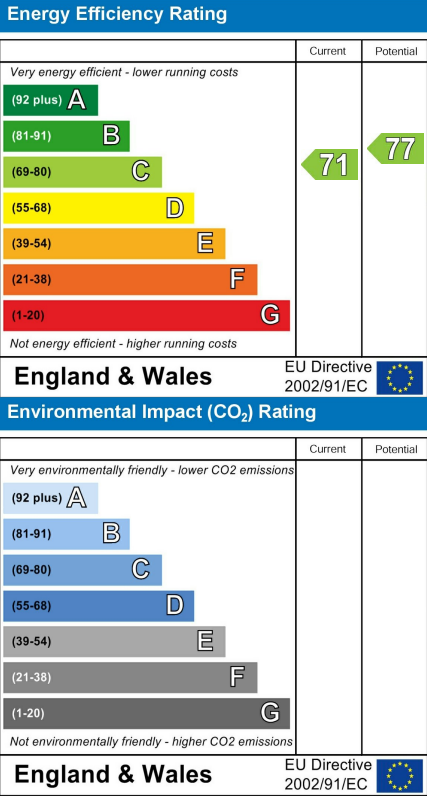

These particulars, whilst believed to be accurate are set out as a general outline only for guidance and do not constitute any part of an offer or contract. Intending purchasers should not rely on them as statements of representation of fact, but must satisfy themselves by inspection or otherwise as to their accuracy. No person in this firms employment has the authority to make or give any representation or warranty in respect of the property.

(020) 8871 1729 | WWW.CSCOTTANDCO.COM

Registered Address: 203 West Street, Fareham, PO16 0EN

Company Registration Number: 11928484